

**DAF**

SILENT-BLOCO DAF TRAILER  
(60X68XF30)



SLBL-0981

PLASTIBORRACHA,LDA

SILENT-BLOCO MOLAS DAF  
(45X82X75XF16)



SLBL-1486

PLASTIBORRACHA,LDA

SILENT-BLOCO MOLAS DAF 45  
(46x106x102x22)

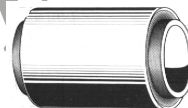

SLBL-1513

PLASTIBORRACHA,LDA

SILENT-BLOCO CAVILHA DAF 95  
(d51X77Xc140X32)

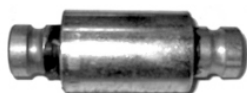

SLBL-1140

PLASTIBORRACHA,LDA

BATENTE DE MOLA DAF  
(85X11X25MM)



APMT-0993

PLASTIBORRACHA,LDA

BATENTE DE MOLA DAF  
(75X11X25MM)



APMT-1070

PLASTIBORRACHA,LDA

SILENT-BLOCO CAVILHA DAF (95)  
(d50,5X100Xc143x34)

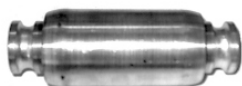

0654792

SLBL-1064

PLASTIBORRACHA,LDA

CASQUILHOS AMORTECEDORES  
(49X28XF23MM)

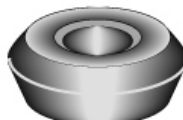

CSNI-1059

PLASTIBORRACHA,LDA

SILENT-BLOCO MOLAS DAF (L80)  
(f.23xD62x85x69)



1357764

SLBL-1614

PLASTIBORRACHA,LDA

BATENTE BARRA ESTABILIZADORA  
(105X75X90XF40)



BBES-090002P

PLASTIBORRACHA,LDA

SEPARADOR DE MOLA DAF  
(82X66X7MM)



BBES-09012P

PLASTIBORRACHA,LDA

APOIO DE CABINE DAF  
(135X90X65X4FX14MM)



APMT-19435

PLASTIBORRACHA,LDA

BATENTE DA MOLA DAF  
(95X62X24X2PM10)



APMT-0912

CASQUILHOS AMORTECEDORES  
(d.58X20XF16)



CSBO-10906

(D.58x20xf21)

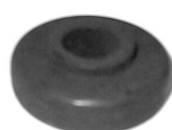

CSBO-10906F21

CASQUILHOS DE AMORTECEDOR  
(60X20XF20MM) (60X25XF20MM)=1057

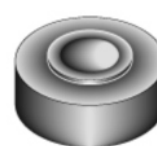

CSBO-870-MP

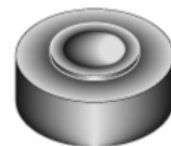

CSBO-870-MG



DAF

SILENT-BLOCO DAF Lf45  
(D37XC48/30XF17)



1400 396  
ACHF431

SLBL-1645

PLASTIBORRACHA,LDA

SILENT-BLOCO MOLAS DAF 75 - 85 - 95  
(D.61XF24XC86-81MM)



SLBL-1697

PLASTIBORRACHA,LDA

PLASTIBORRACHA,LDA

PLASTIBORRACHA,LDA

PLASTIBORRACHA,LDA

PLASTIBORRACHA,LDA

PLASTIBORRACHA,LDA

PLASTIBORRACHA,LDA

PLASTIBORRACHA,LDA

PLASTIBORRACHA,LDA

PLASTIBORRACHA,LDA

PLASTIBORRACHA,LDA

PLASTIBORRACHA,LDA

PLASTIBORRACHA,LDA

PLASTIBORRACHA,LDA

PLASTIBORRACHA,LDA

PLASTIBORRACHA,LDA

PLASTIBORRACHA,LDA

PLASTIBORRACHA,LDA

PLASTIBORRACHA,LDA

PLASTIBORRACHA,LDA

PLASTIBORRACHA,LDA

PLASTIBORRACHA,LDA

PLASTIBORRACHA,LDA

PLASTIBORRACHA,LDA

PLASTIBORRACHA,LDA

PLASTIBORRACHA,LDA

PLASTIBORRACHA,LDA